



## TALLAHASSEE

4215 SF, 3 Bedrooms, 3.5 Baths



An open-concept single story floorplan designed to maximize living space. This modern farmhouse boasts an open kitchen, spacious great room, and large front and rear porch area for entertaining.

Upon entering this home through double doors, you will pass the dining room and foyer, the kitchen and its spacious island becomes the focal point, highlighting the heart of the home.

2 bedrooms with walk in closets and bath are tucked to one side of the home while the owner's suite is privately located on the other side. The master suite has his and her vanities and free-standing tub with large shower.

The mud room area adds a half bath and large laundry room that can be accessed from the master closet.

Need more space, add the bonus room with full bath and walk in closet.



# TALLAHASSEE

4215 SF, 3 Bedrooms, 3.5 Baths

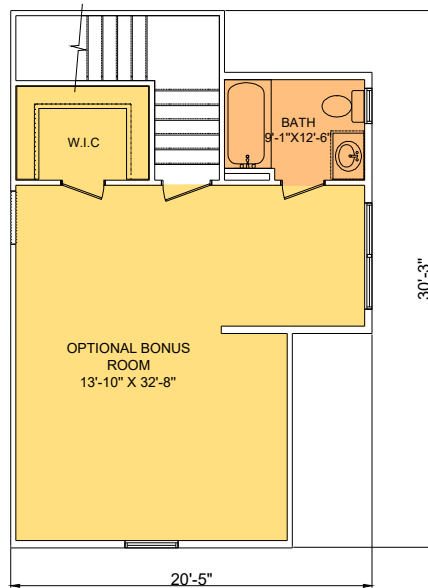

Square Footage	
Total	4215
1st floor heated	2410
2nd floor heated	463
Porches	639
Garage	703