



## The Kennesaw

4880 SF, 5 bedrooms, 3.5 baths and 2 car garage



This magnificent Rustic Farmhouse plan features a luxurious exterior and an interior to match. The large country inspired front covered porch is a great spot to relax and there is a rear covered porch that you can entry from nook and Master bedroom. This is great space for entertaining or just enjoy all "Mother Nature" has to offer. The floorplan features approximately 3516 square feet of living space on two floors and offers 5 bedrooms and three plus baths. Along with a two car garage.

The interior of the plan features the owner's suite on the main floor which showcases a bedroom, a luxury bath with both a shower and freestanding tub along with an enclosed toilet room. There is even a door access from the primary suite's closet into the laundry room and mud room for convenience. From the garage into the home, you'll find mud room and closet area along with a half bath and storage room. The main living areas of the house are located at the opposite end of the home and include a kitchen with a large center island, a dining space that can be entered by the kitchen. All the living spaces are enveloped by the rear covered porch making for a wide-open feel to the home as well as plenty of exterior access. The second-floor features four additional bedrooms, two baths.

Bedrooms two and five share a jack and Jill bath. The fourth bedroom has an adjacent bath and both the loft and optional bonus room have huge amounts of floor space. This is a great home for a large family with plenty of space on the interior and exterior.

## The Kennesaw

4880 SF, 5 bedrooms, 3.5 baths and 2 car garage

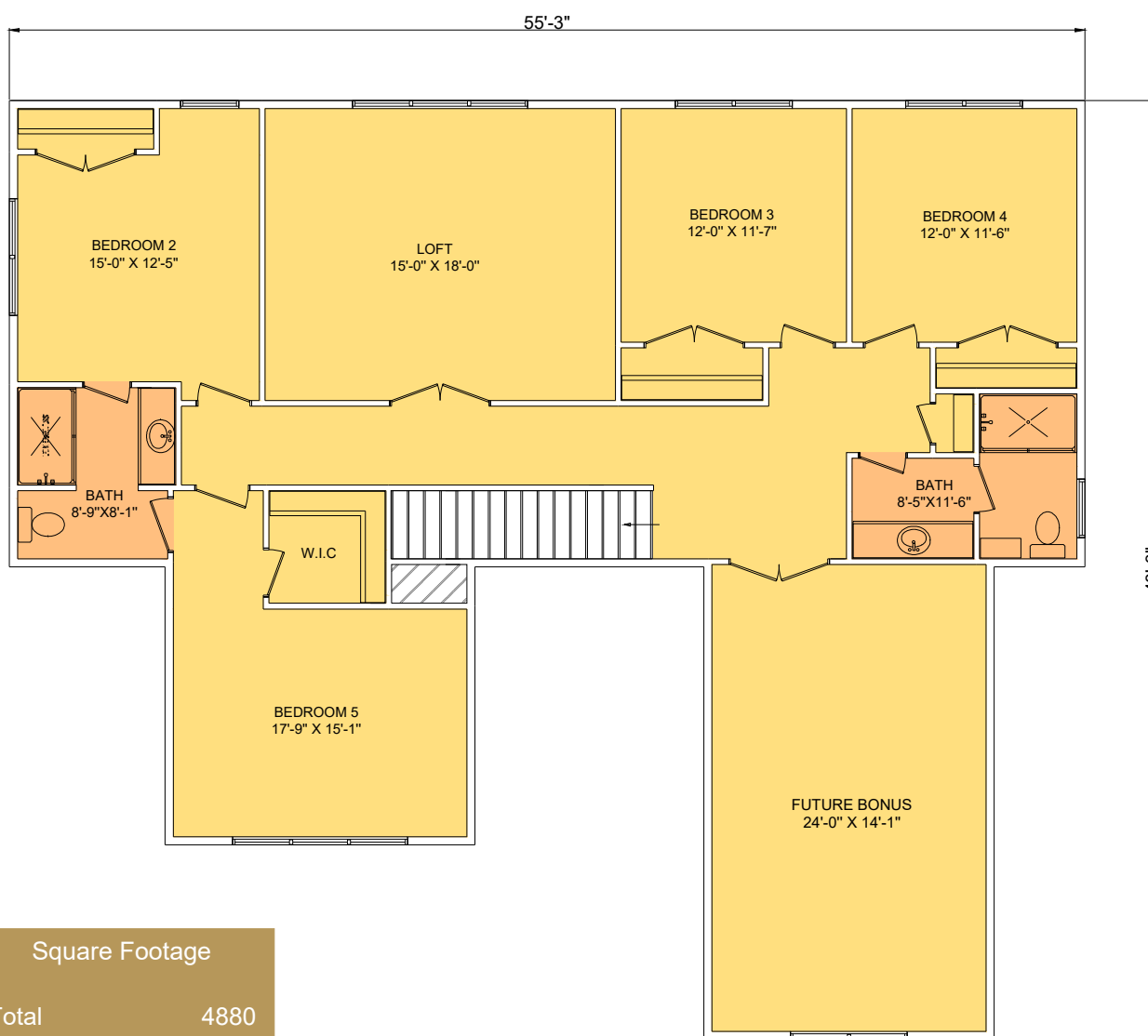

Square Footage	
Total	4880
1st floor heated	1988
2nd floor heated	1528
BONUS RM	356
Porches	481
Garage	527